

Key Path 1: Onboarding

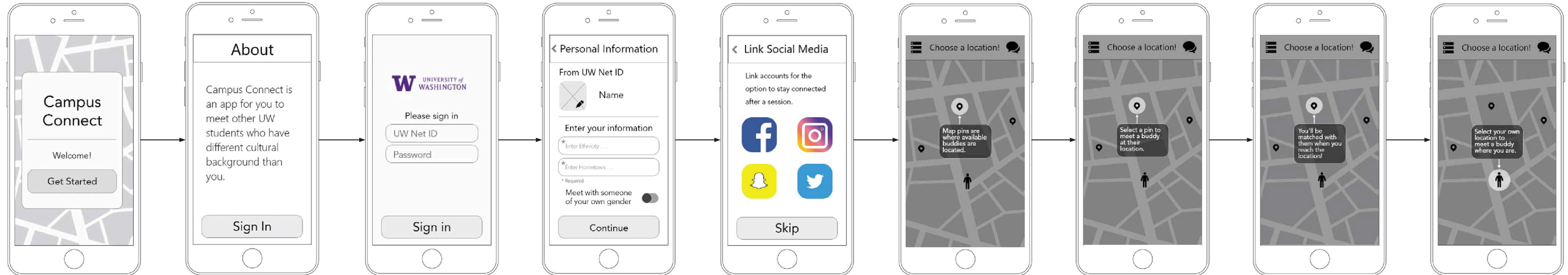

User greeted with a welcome screen

About page gives user context and purpose

User signs in with UW NetID to ensure safety

User fills in personal information and can edit information from UW NetID

User can optionally link social media

Tutorial page 1 explains buddy pins on the map

Tutorial page 2 explains how to meet a buddy by clicking on their pin

Tutorial page 3 explains when the user will be matched

Tutorial page 4 explains how to meet a buddy at your location

Key Path 2: Find buddy at a location, match, chat, and share contact

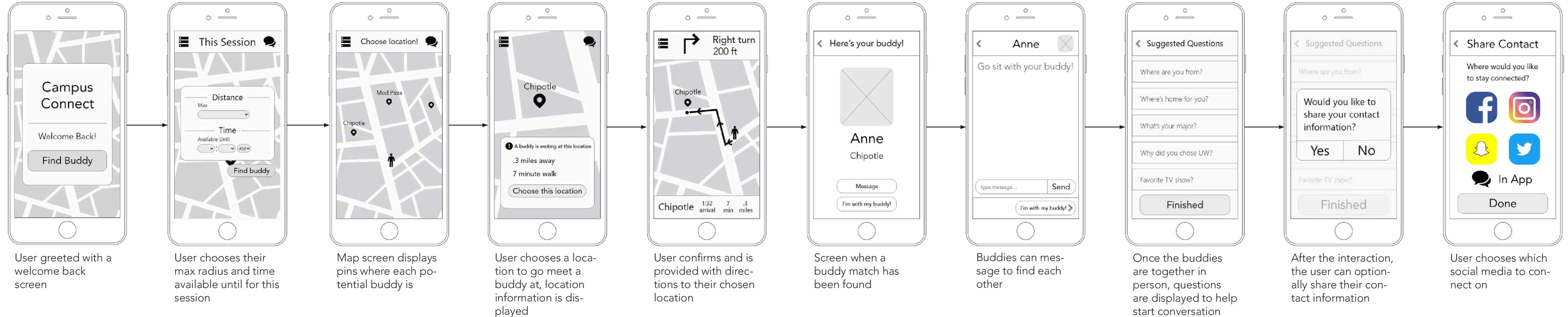

Key Path 3: Wait and match with a buddy at your location

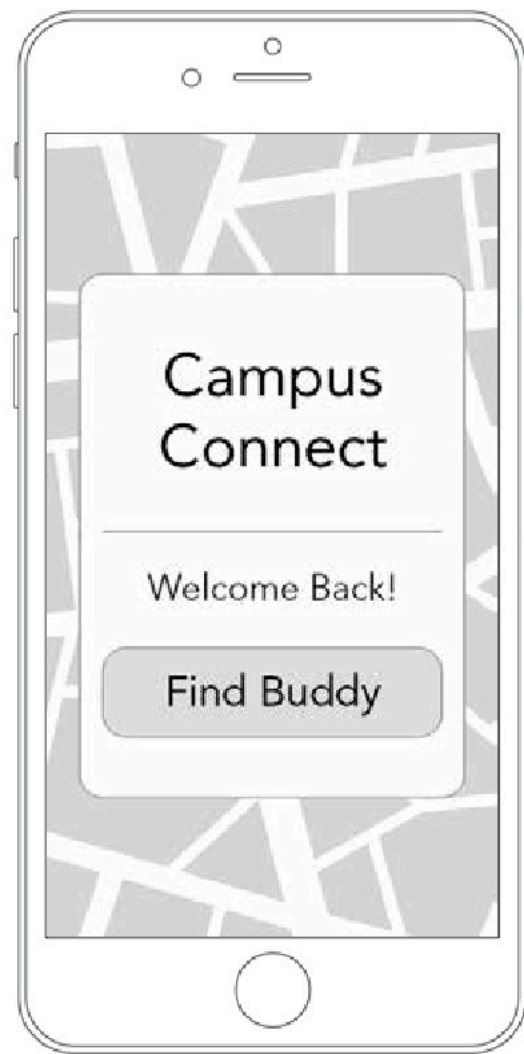

User greeted with a welcome back screen

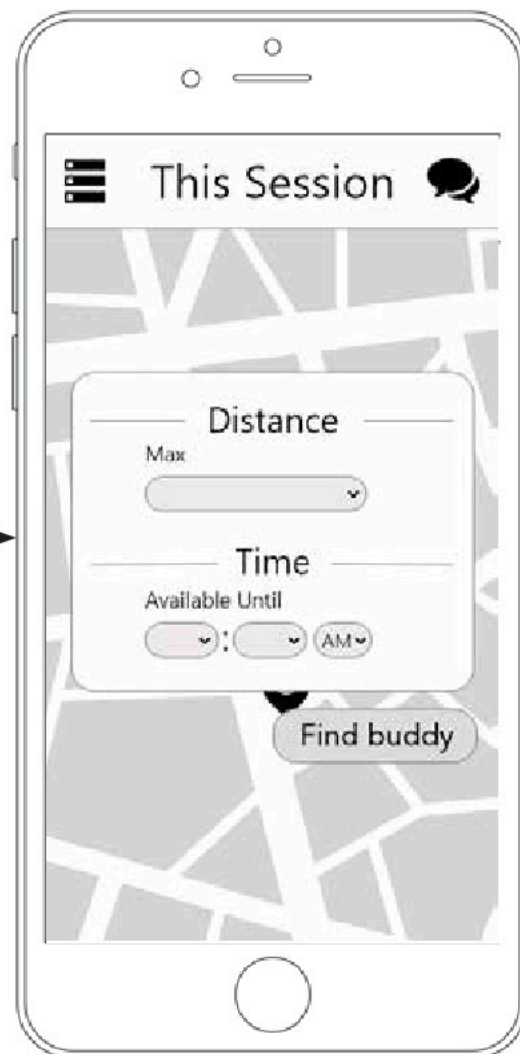

User chooses their max radius and time available until for this session

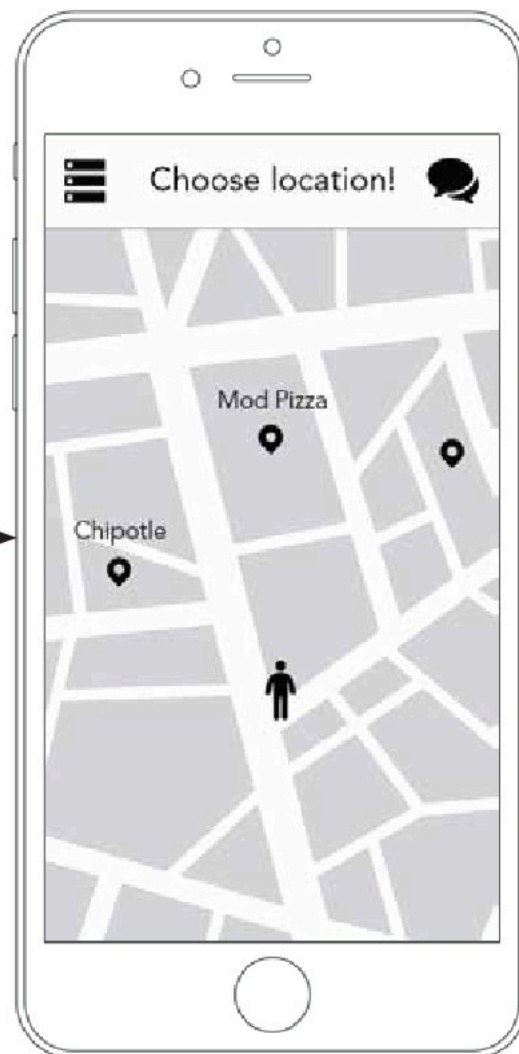

Map screen displays pins where each potential buddy is

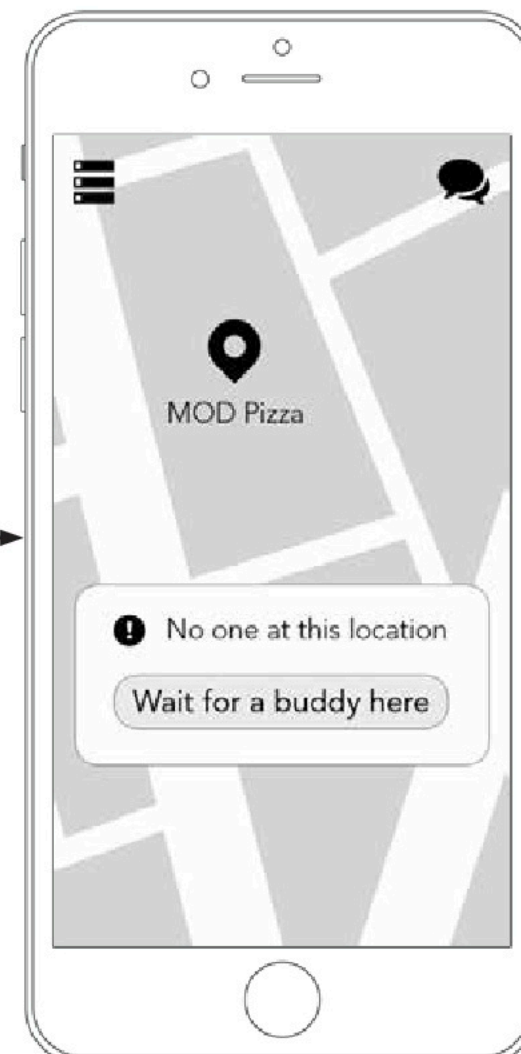

If no buddy is at the location, the user can choose to wait for a buddy



User waits for a buddy and can cancel



When a buddy reaches their location, the user is matched with them